

Approx Gross Internal Area
57 sq m / 618 sq ft

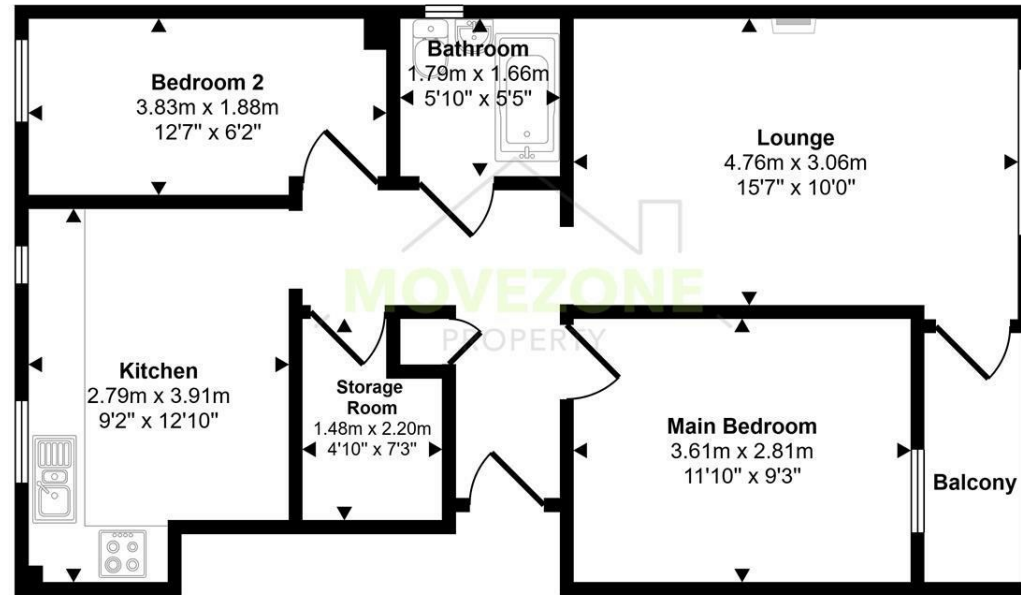

Floorplan

This floorplan is only for illustrative purposes and is not to scale. Measurements of rooms, doors, windows, and any items are approximate and no responsibility is taken for any error, omission or mis-statement. Icons of items such as bathroom suites are representations only and may not look like the real items. Made with Made Snappy 360.



Directions

Contact

223 Southborough Lane
Bromley
Kent
BR2 8AT

E: info@movezone.co.uk

T: 0208 3139075

<https://www.movezone.co.uk>



2 Bed
Flat
located in



54 Hope Close

London
SE12 0BJ

£1,850 PCM



An excellent opportunity to rent this well presented two bedroom flat, ideally located on Hope Close, SE12, set within a quiet residential Close. Offering well proportioned accommodation and a peaceful setting, this property is sure to let quickly, early viewing is highly recommended.

The accommodation comprises a bright living room with access onto a private balcony, two bedrooms, a spacious modern kitchen with appliances, and a lovely modern bathroom. An additional small room provides useful extra space, ideal for storage, a study area or similar. Further benefits include gas central heating and double glazed windows. Permit parking is also available within the close.

Ideally located under a 5 minute walk from Grove Park station, the property offers excellent transport links into Central London. Local shops and amenities are also nearby, making this an ideal home for commuters, couples or families seeking convenience in a quiet and well connected location.

Contingency Deposit: £2,134
EPC Rating: D
Council Tax Band: B

